



### FEATURES:

- Fault monitoring, heatsink temperatures and speaker loads for each amplifier viewable via front panel LCD
- Announcing group assignment for each amplifier configured via front panel LCD and encoder
- Interfaces with E&M trunk lines or analog lines for announcements through a PBX system. (VoIP coming soon)
- Provides up to 3,000 watts of audio power via 12 250 watt Class D amplifier modules based on a continuous sinusoidal 1 KHz input signal at 55°C.
- Amplifiers provide for dynamic attenuation with excessive loading and automatic disconnection from load for short circuit protection. All amps have transformer isolation.
- Modular amplifiers include the capability of automatically switching the load from a faulty amplifier to a spare
- Includes 5KVA Inverter, Battery Chassis, Enhanced Alarm Module and Trunk Module
- Amplifier chassis fits in standard EIA 19" rack.
- Replaces the equivalent legacy equipment: (Qty 3 AM-2316E/SIA 1,000 watt amplifiers and Qty 1 AN/SIA-114, AN/SIA-117 or AN/SIA-118 amplifier-oscillator control group.)
- Dual digital trunks can network up to 64 DIAS nodes.

### RELATED EQUIPMENT

EQUIPMENT	DYNALEC PART #
MIC STATION .....	60173-000-10
AMPLIFIER MODULE, 250 WATT .....	60173-370
DCCF, DIAS Cross Connect Field .....	60173-900

ENVIRONMENTAL CHARACTERISTICS

TESTED TO:

Shock .....	MIL-STD-901D
Vibration .....	MIL-STD-167-1
EMI .....	Mil-Std-461
Temperature .....	55°C

Height .....	74.00"
Width .....	24.25"
Depth .....	37.36"
Weight .....	1,026 lbs

OUTLINE DRAWINGS

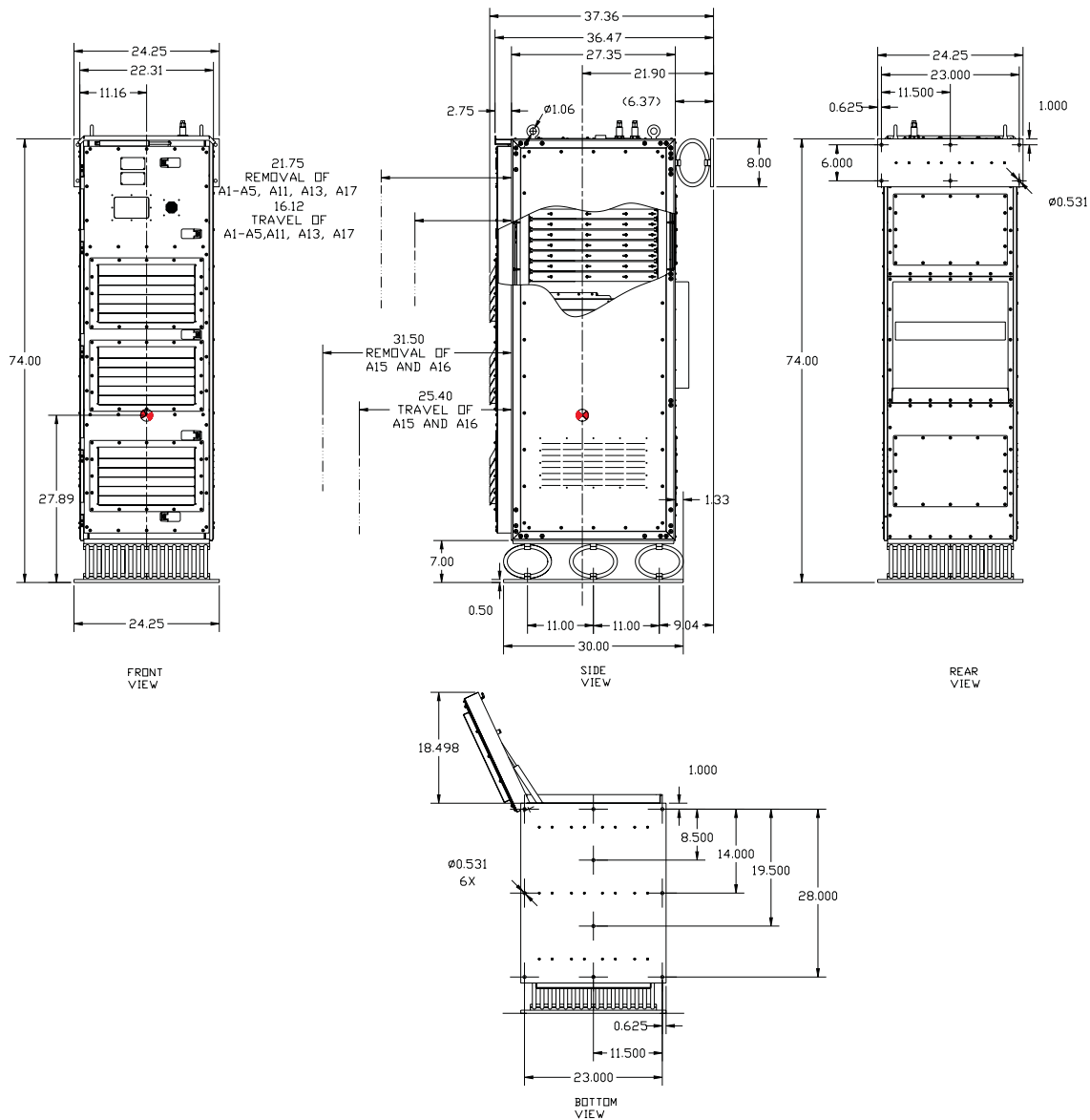

87 WEST MAIN STREET  
SODUS, NEW YORK 14551

Telephone  
Fax  
Internet

315-483-6923  
315-483-6656  
www.Dynalec.com